

# MUTO PLANKT

acoustic panel &  
tile solutions

---

SOELBERG



# MUTO PLANKT

## acoustic panel & tile solutions

Rich textural wood grains that absorb sound? Yes, MUTO Wooded Plankt Tiles and Panels are your solution for designing with wood planks that not only look real but perform acoustically for you too. Printed wood grains on PET felt make it easy to introduce the natural beauty of wood that softens sound at the same time.

Make It Cool. Make It Quiet.

## SPECIFICATION

<b>CONTENT</b>	100% POLYESTER (PET) FELT
<b>CORE THICKNESS</b>	1" (24MM) FELT
<b>PATTERNS</b>	PLANKT PANEL H (HORIZONTAL) PLANKT PANEL V (VERTICAL) PLANKT TILE H (HORIZONTAL) PLANKT TILE D (DIAGONAL)
<b>GRAINS</b>	8 WOODED GRAINS
<b>SIZE</b>	23.75" x 23.75"   TILE 47.5" x 96"   PANEL
<b>WEIGHT</b>	3/4 LB   SQUARE FOOT
<b>ACOUSTICS</b>	NRC 0.75
<b>FIRE RATING</b>	CLASS A   ASTM - E84
<b>ENVIRONMENTAL</b>	DECLARE LABEL & MINDFUL MATERIALS MUTO IS PRODUCED FROM 100% RECYCLABLE PET FELT WITH NO ADDED UREA FORMALDEHYDE AND SHOULD BE RECYCLED THROUGH THE NORMAL WASTE SYSTEM.
<b>LEAD TIME</b>	2 - 3 WEEKS
<b>WARRANTY</b>	2 YEARS

MUTO Plankt panels and tiles consist of 1/2" PET felt wooded print grain planks adhered to 1/2" PET felt Graphite backer panel. Choose from 8 different wood grains.

Planks are 4" nominal. Planks are not continuous from horizontal panels and tiles to vertical panels or diagonal tiles. For continuous plank size and spacing, order the same panel or tile orientation.

## MAINTENANCE

Vacuum to remove dirt and dust. Remove spills or spots immediately using a clean damp cloth. Carpet and fabric cleaners can also be used to clean. (Always test an inconspicuous area first.) Compressed air may be used to dust in difficult or hard-to-reach areas.

To disinfect, bleach can be used in accordance with CDC Cleaning & Disinfection instructions. The solution ratio is 5 tablespoons of bleach to 1 gallon of water | 4 teaspoons of bleach to 1 quart of water. Apply solution by spray and wipe off immediately. (Always test in an inconspicuous area first.)





# WOODED COLOR

## MATTE FINISH

8 STANDARD WOODED GRAINS FOR PLANKS  
GRAPHITE COLOR BACKER PANEL  
100% RECYCLABLE PET FELT

## TOLERANCES

PET felt is made from 100% recyclable polyester plastic. Slight and consistent variations in color, density, texture are inherent to this core material and should be expected. Color, density and texture will vary by dye lot. MUTO is made with a 'felling' process which results in a textural heathered effect where the fibers consist of multiple tones and shades.



WHITE WASHED OAK



BLONDE MAPLE



AGED ASH



SMOKED ASH



NATURAL WALNUT



BLACK WALNUT



WEATHERED PINE



CHARRED OAK

# SIZE

## PLANKT PANEL H

45.5" x 96" PANEL SIZE  
NOMINAL 4" HORIZONTAL PLANKS

## PLANKT PANEL V

45.5" x 96" TILE SIZE  
NOMINAL 4" VERTICAL PLANKS

## PLANKT TILE H

23.75" x 23.75" TILE SIZE  
NOMINAL 4" HORIZONTAL PLANKS

## PLANKT TILE D

23.75" x 23.75" TILE SIZE  
NOMINAL 4" DIAGONAL PLANKS

# SEAM REPEAT

Plankt horizontal or vertical tiles and panels are manufactured with a reveal edge so plank spacing will continue from tile to tile or panel to panel. Diagonal tiles do not have a reveal edge and can continue in one direction or in a 'chevron-like' pattern.

Plankt planks are 4" nominal but do not run continuous from horizontal panels or tiles to vertical panels or diagonal tiles. For continuous planks, select plank orientation and desired panel or tile quantities.

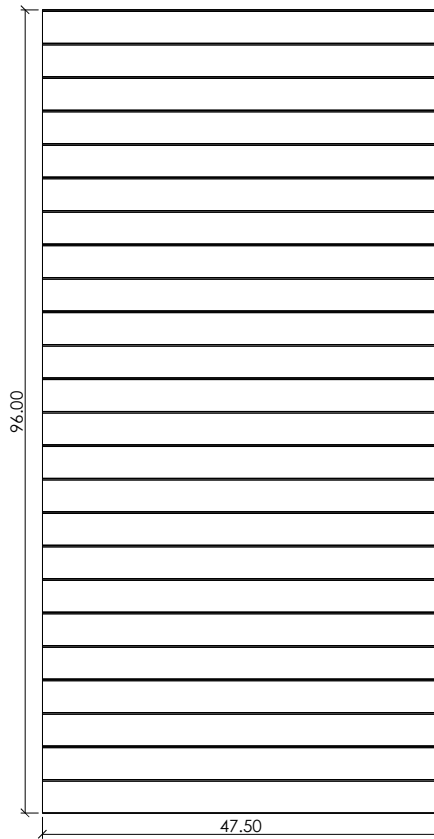

PLANKT PANEL H

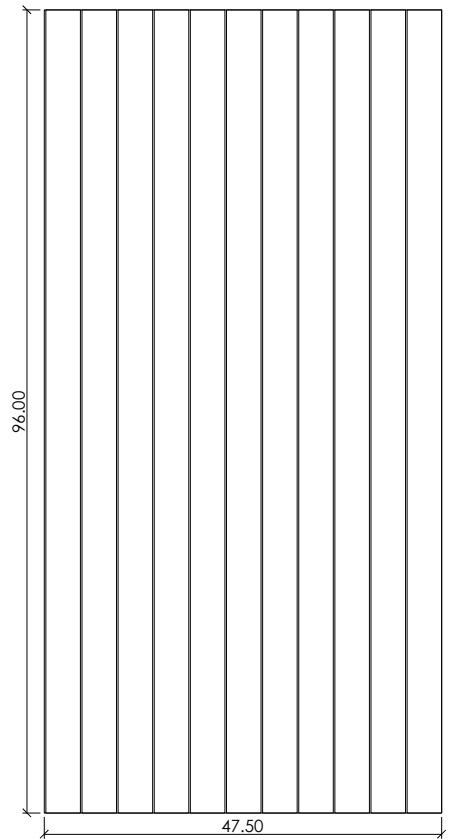

PLANKT PANEL V

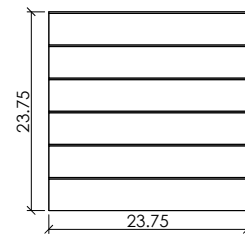

PLANKT TILE H

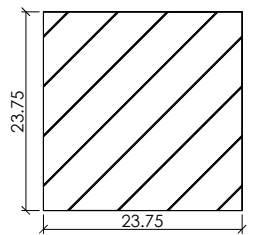

PLANKT TILE D

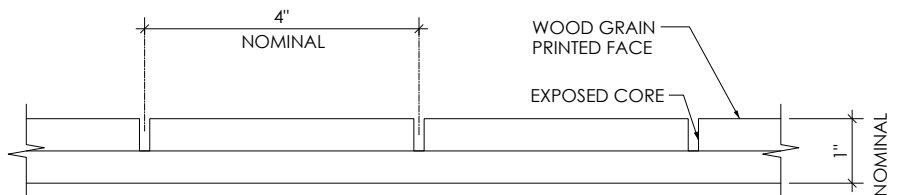

# ACOUSTICS

## NRC TEST DATA

Higher NRC ratings mean higher sound absorbency. The performance of MUTO Texture increases with an air gap between panel and wall.\*

NRC values will vary based on customization and specific installation details. Contact your sales representative to learn more.

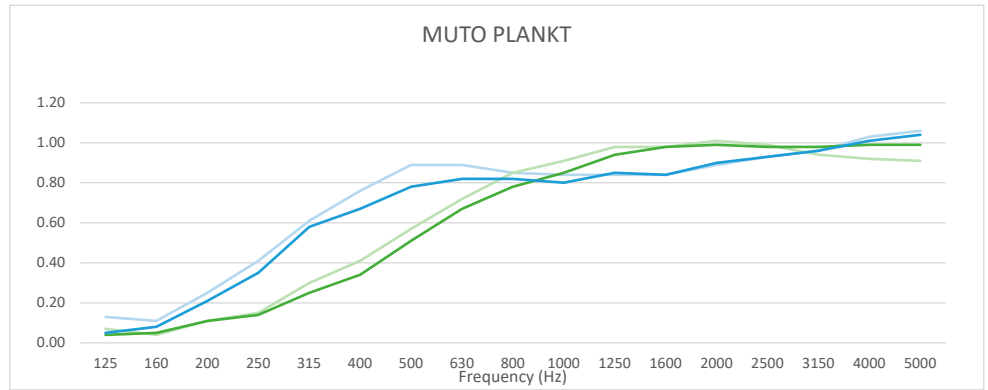

PRODUCT	MOUNTING	SAMPLE FREQUENCY (Hz)				NRC
		250	500	1000	2000	
1" PLANKT	DIRECT	0.35	0.78	0.80	0.90	0.70
	Z-CLIP	0.41	0.89	0.84	0.89	0.75
1" MUTO	DIRECT	0.16	0.60	0.84	0.95	0.65
	Z-CLIP	0.18	0.68	1.00	1.09	0.75

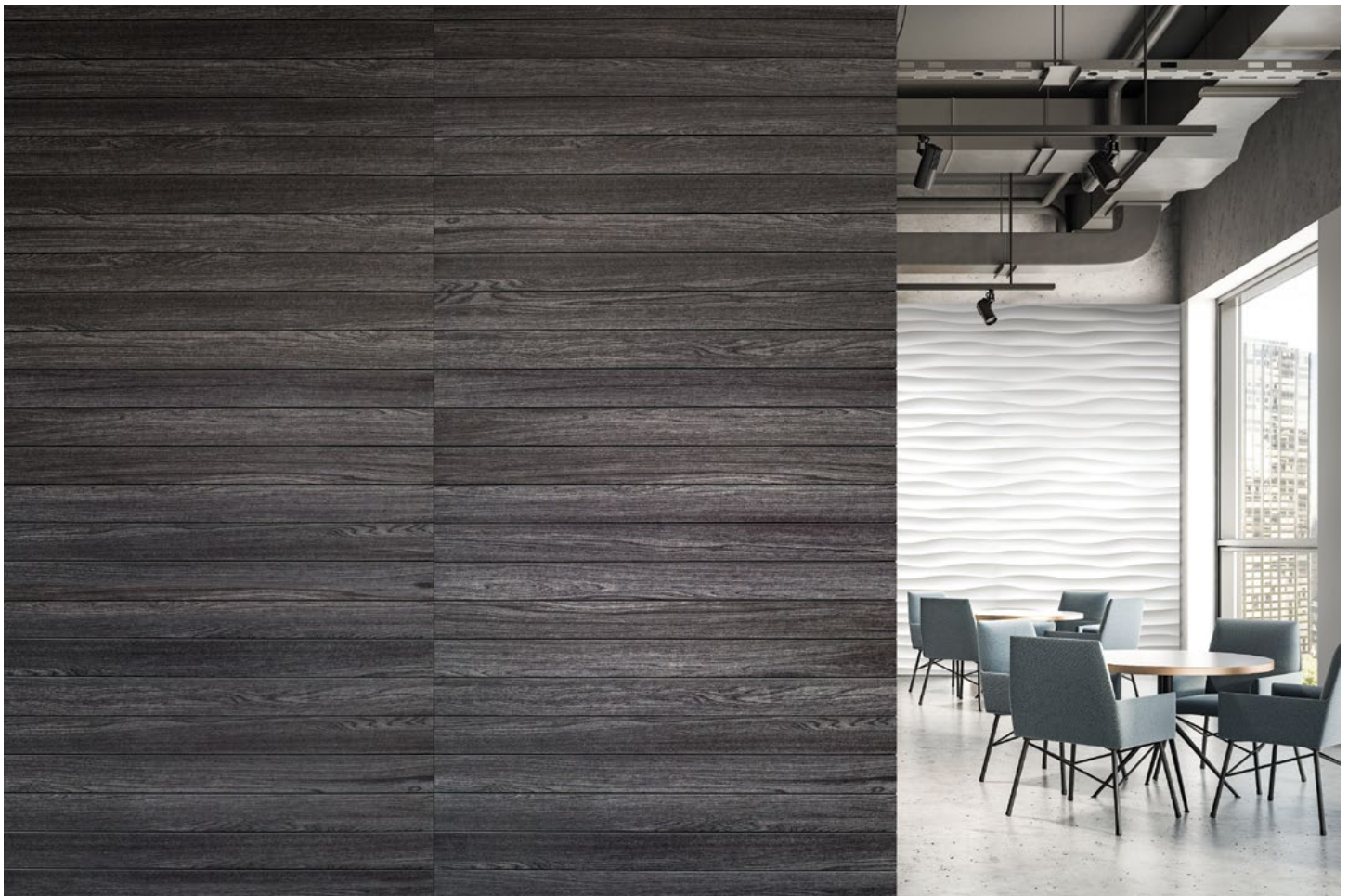

# ENVIRONMENTAL

## DECLARE & MINDFUL MATERIALS

We care about the environment and it matters that our materials support healthy and productive interior spaces. We use innovative materials but ensure that they meet the highest level of standards and expectations.

MUTO PET felt core material is 100% recyclable with no added urea formaldehyde.





# INSTALLATION

## ADHESIVE

Use standard construction adhesives (Liquid Nails | Titebond) and apply to the back of the panel maintaining at least a 1" border around the perimeter. Adhere to substrate providing bracing to hold material in place per adhesive curing time instructions.

## ZCLIP HARDWARE

Attach clips to the back of each panel with screw length to accommodate for the thickness of specified pattern. Anchor to substrate as required.

## STAND OFF HARDWARE

Using barrell and cap, secure panel and anchor to substrate as required. Six anchor points recommended for full sized panel.

